

Specifications

Current rating: 13A AC,DC

Voltage rating: 600V AC,DC

Temperature range: -25°C to +85°C
(including temperature rise)

Contact resistance: Initial value/ 10m Ω Max.

After environmental testing/20m Ω Max.

Insulation resistance: 1000M Ω Min.

Withstanding voltage: 1500V AC/minute

Applicable wire: T1: AWG#14-#20

T2: AWG#18-#24

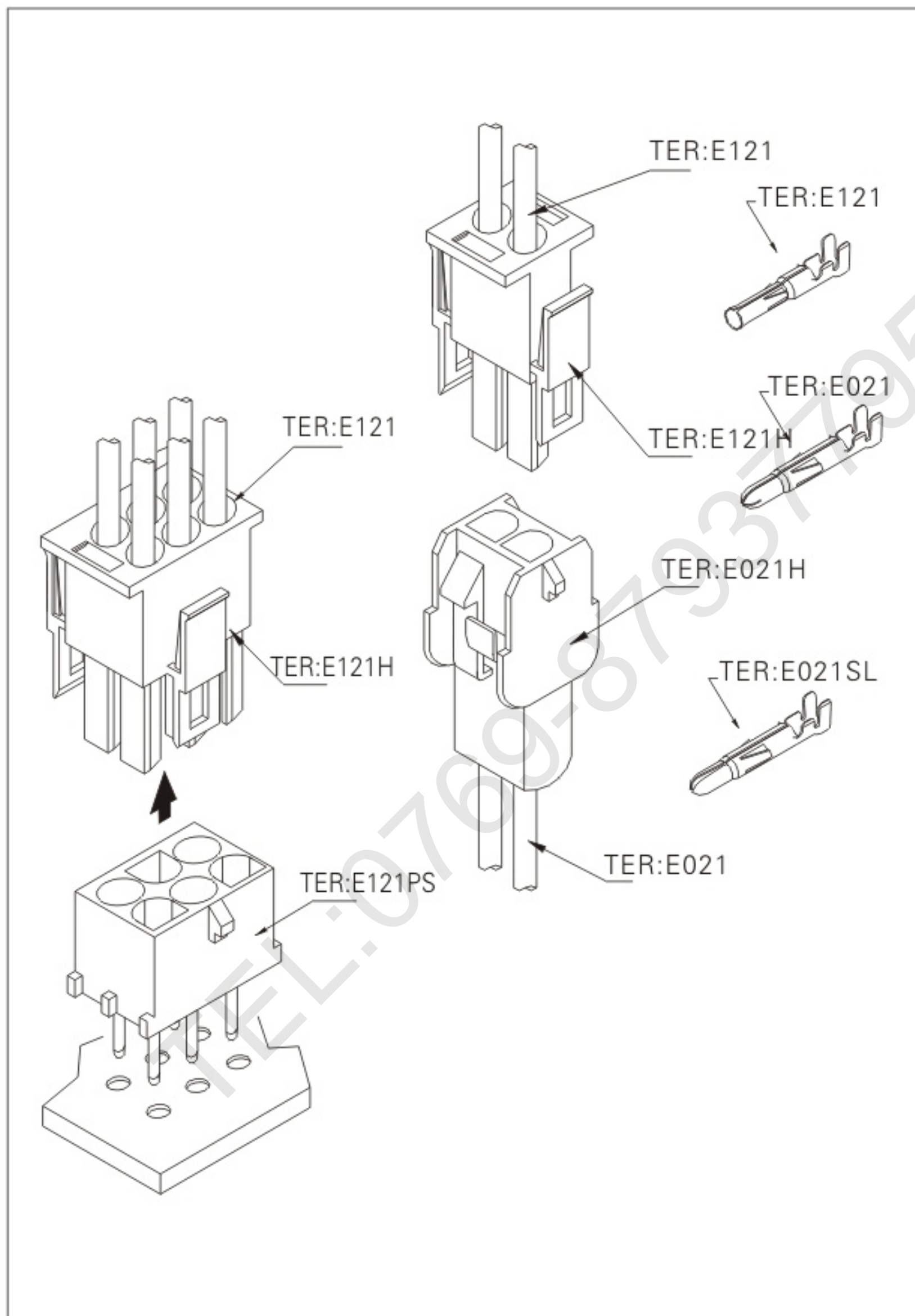

Assembly layout

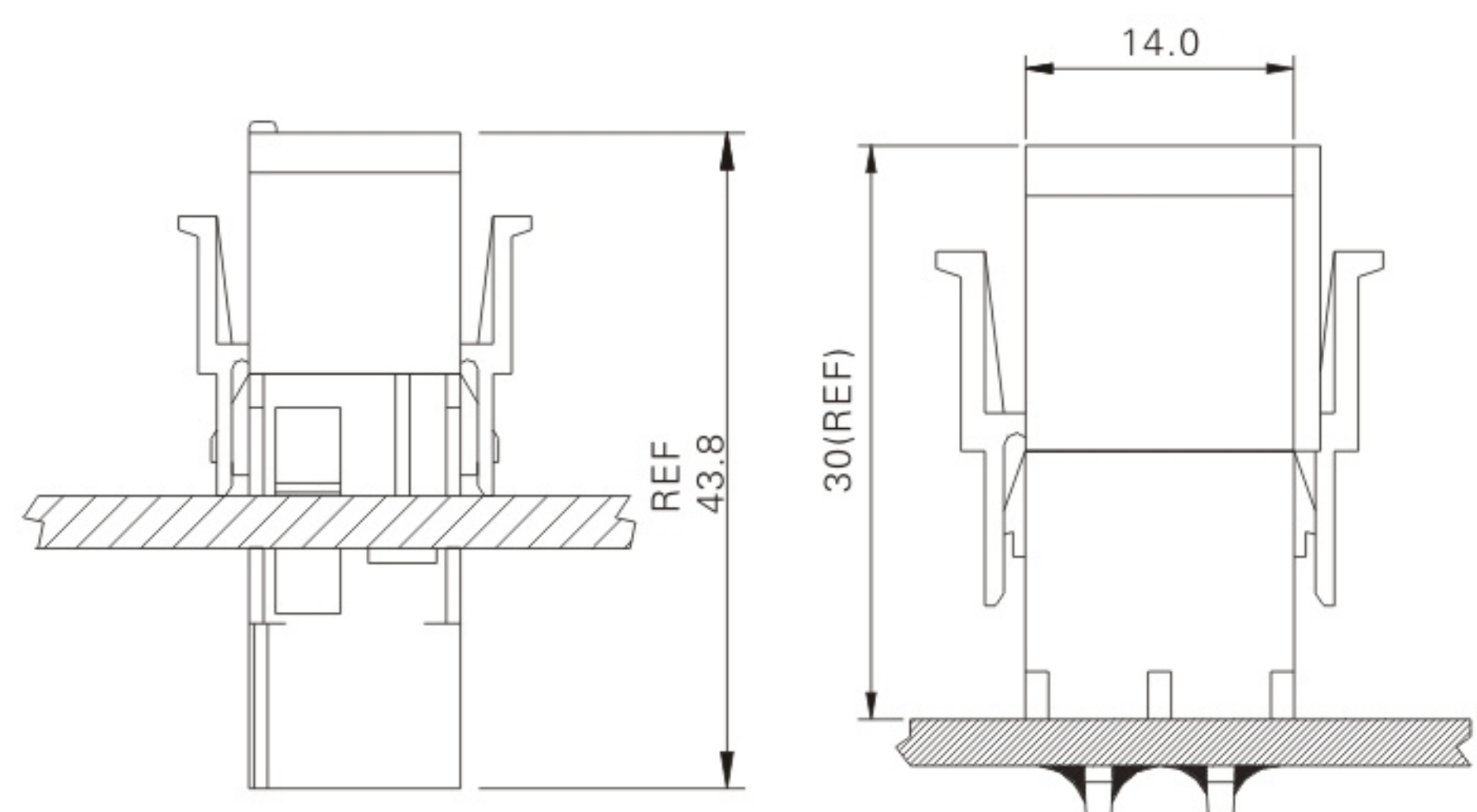

E021 (6.35mm pitch crimp terminal)

Reference Informations:

*Thickness: 0.30mm

*Mates With: E021H series Housing

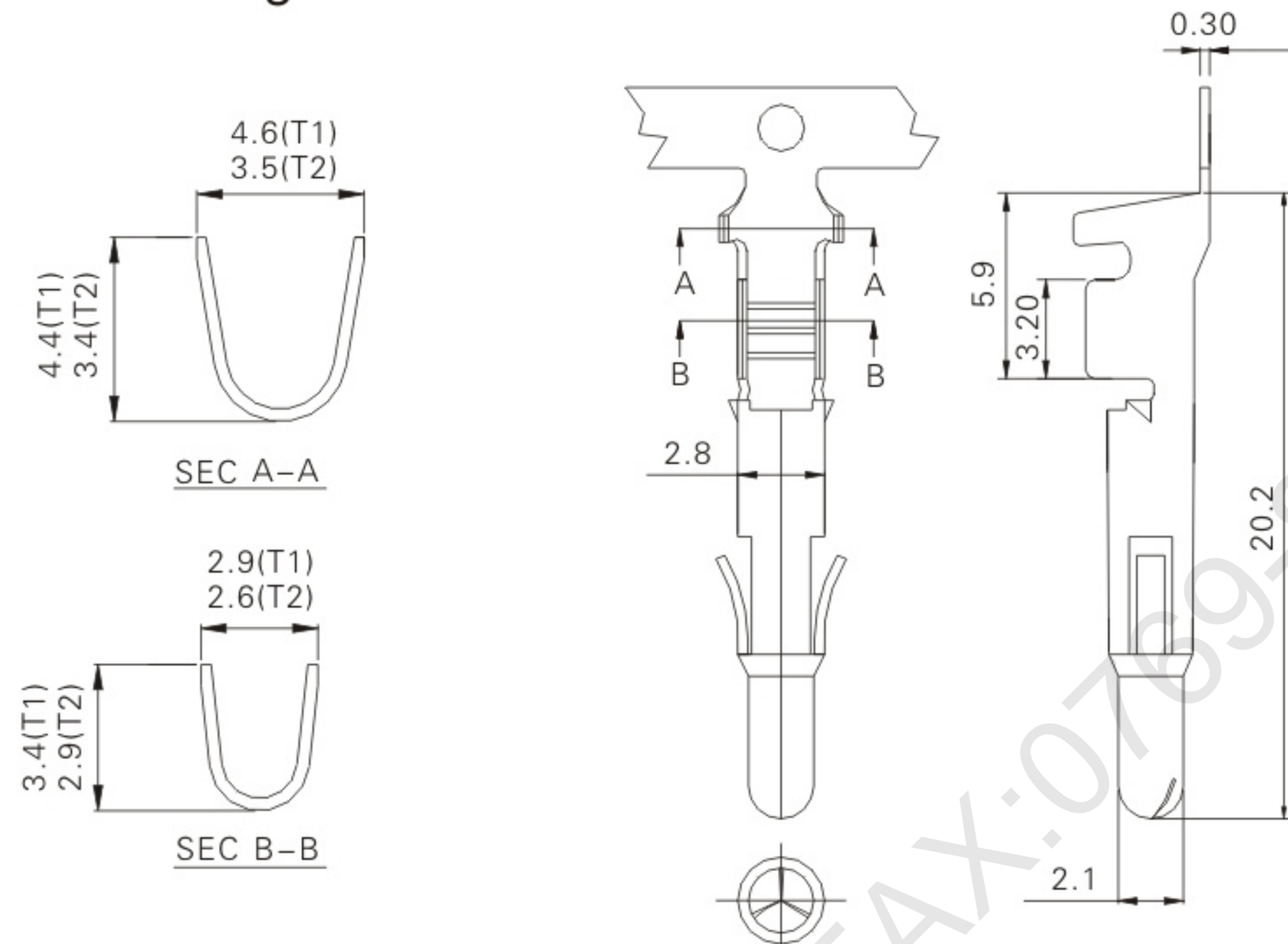

Ordering Information & Specifications

Unit: mm

Part No.	Wire Range	Insulation O.D.	Material	Finish	Qty/reel
E021T1	AWG#20-14	3.4mm(max)	Phosphor	Tin-plated	5000
E021T2	AWG#24-18	3.4mm(max)	Phosphor	Tin-plated	7000

E121 (6.35mm pitch crimp terminal)

Reference Informations:

*Thickness: 0.30mm

*Mates With: E021H series Housing

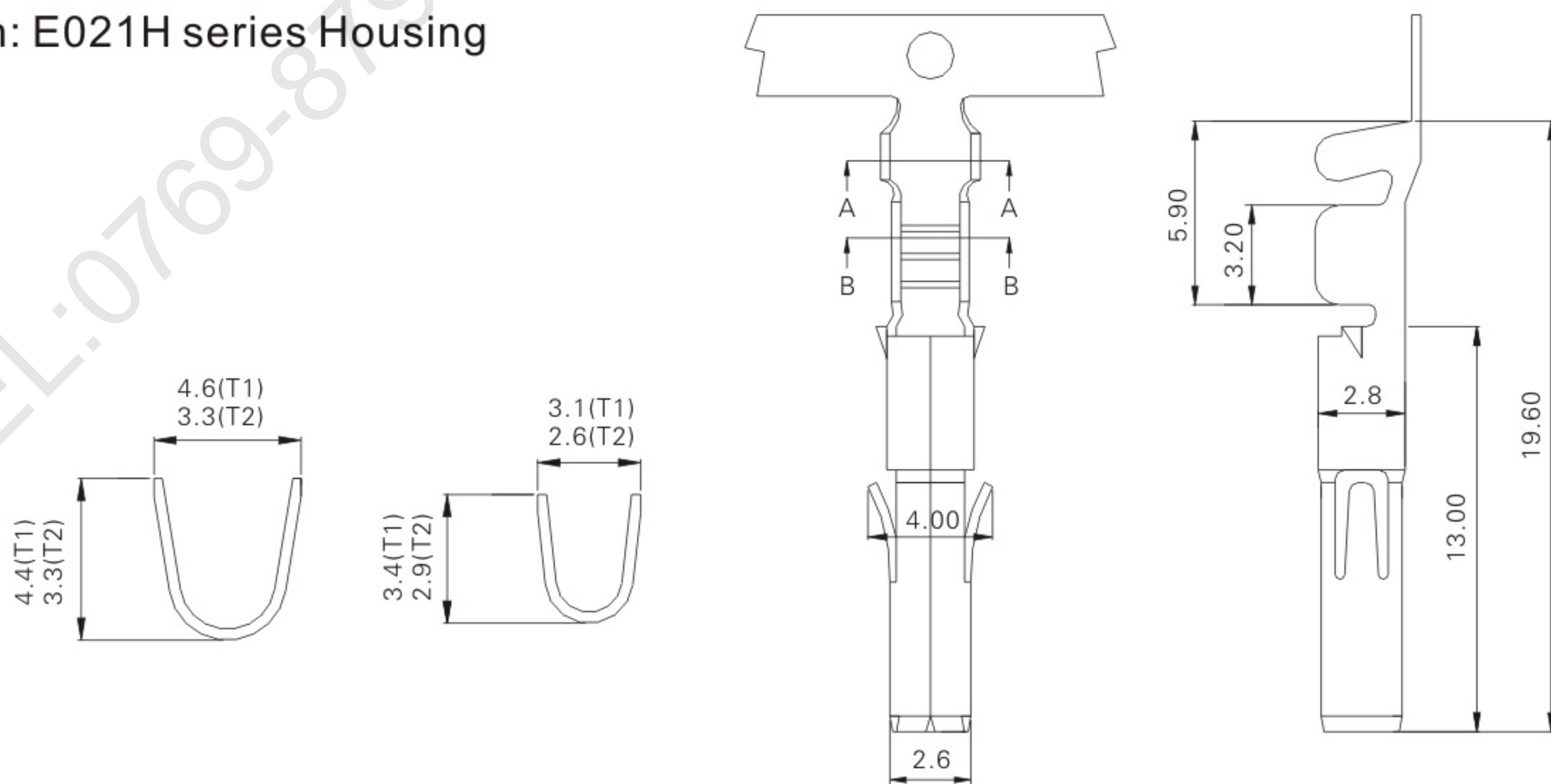

Ordering Information & Specifications

Unit: mm

Part No.	Wire Range	Insulation O.D.	Material	Finish	Qty/reel
E121T1	AWG#20-14	3.4mm(max)	Brosphor	Tin-plated	5000
E121T2	AWG#24-18	3.4mm(max)	Brosphor	Tin-plated	7000

E021H (6.35mm pitch crimp housing)

Reference Informations:

*Mat'l: Nylon 66 UL94 V-2

*Mates With: E021 series Terminal

*Mates With: E121H series Housing

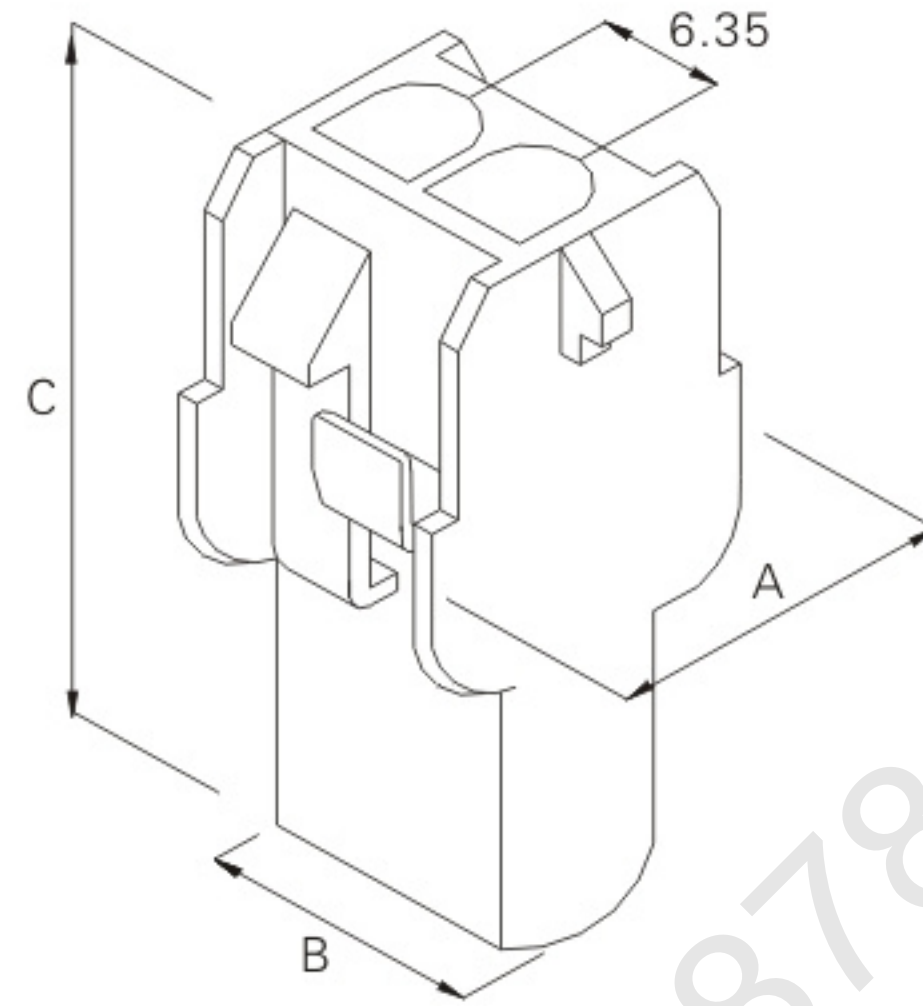
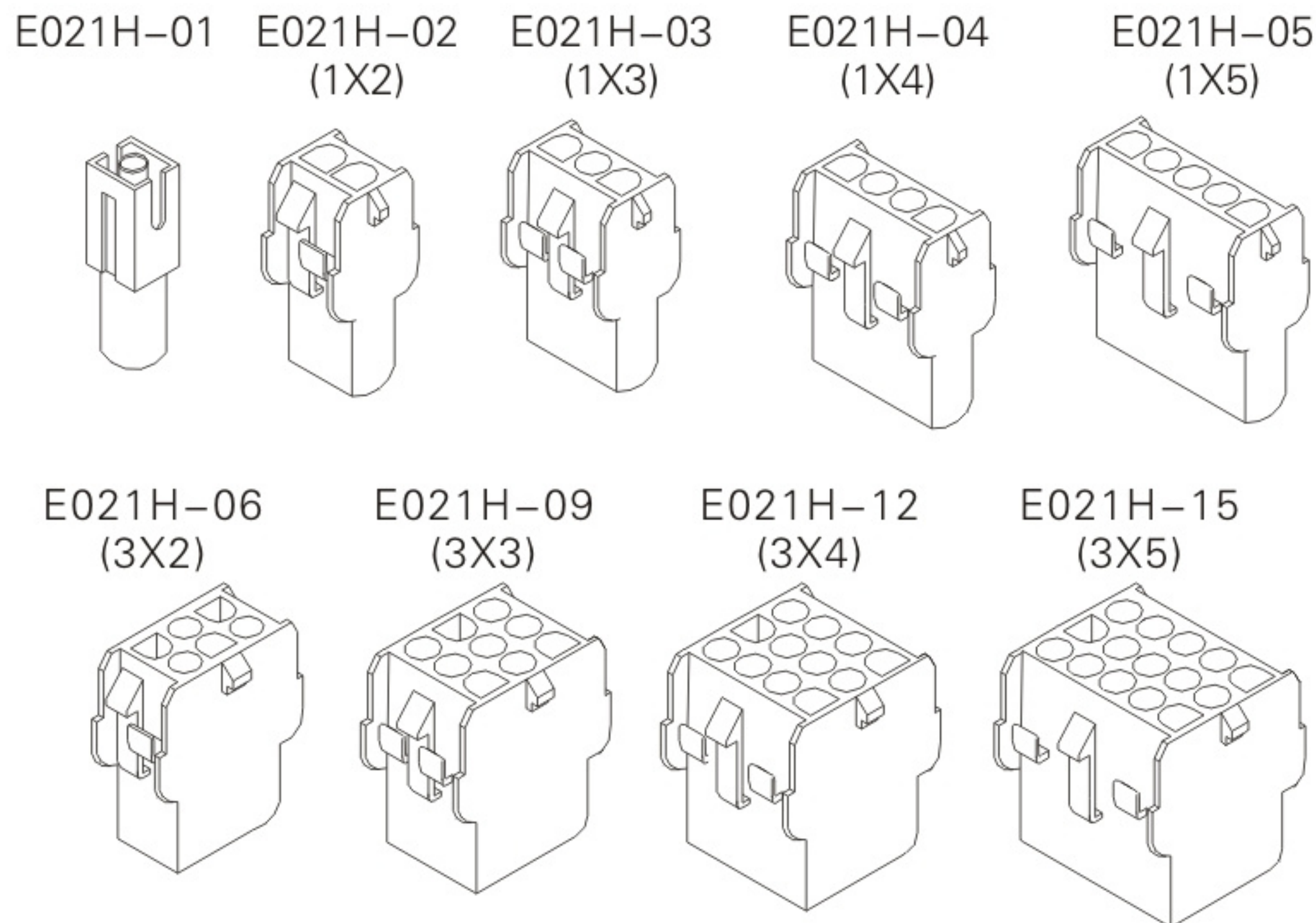

Ordering Information & Dimensions

Circuits	Part No.	DIM.(mm)		
		A	B	C
01	E021H-01	9.6	9.6	27.7
02	E021H-02(1X2)	15.7	14.0	27.6
03	E021H-03(1X3)	15.7	20.4	27.6
04	E021H-04(1X4)	15.7	26.7	27.6
05	E021H-05(1X5)	15.7	33.0	27.6
06	E021H-06(3X2)	28.5	14.0	27.6
09	E021H-09(3X3)	28.5	20.3	27.6
12	E021H-12(3X4)	28.5	26.7	27.6
15	E021H-15(3X5)	28.5	33.0	27.6

E121H (6.35mm pitch crimp housing)

Reference Informations:

*Mat'l: Nylon 66 UL94 V-2

*Mates With: E121 series Terminal

*Mates With: E021 series Housing

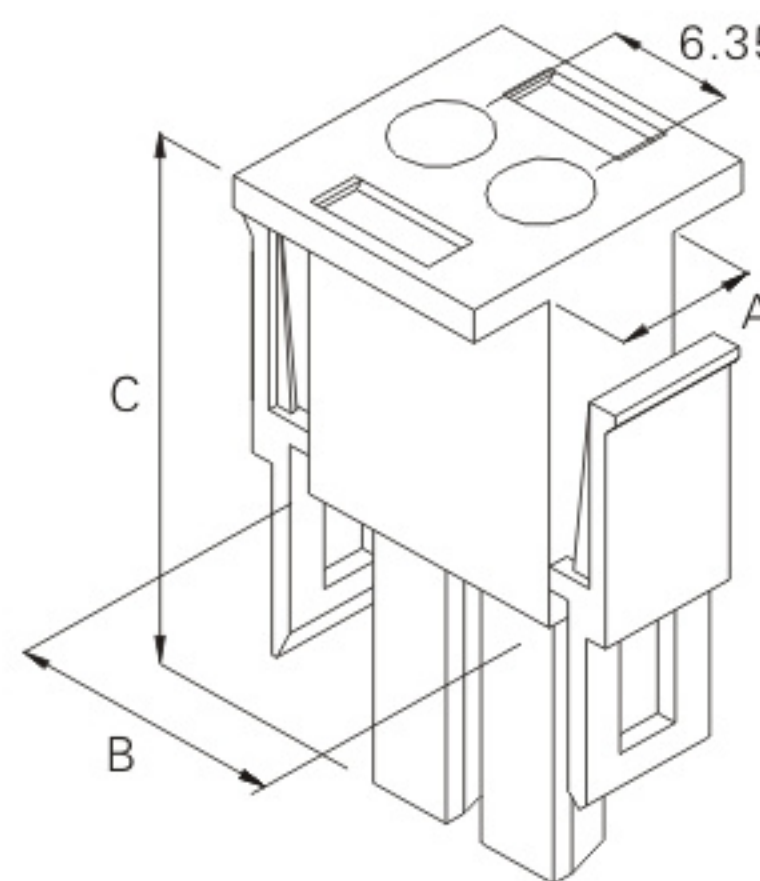
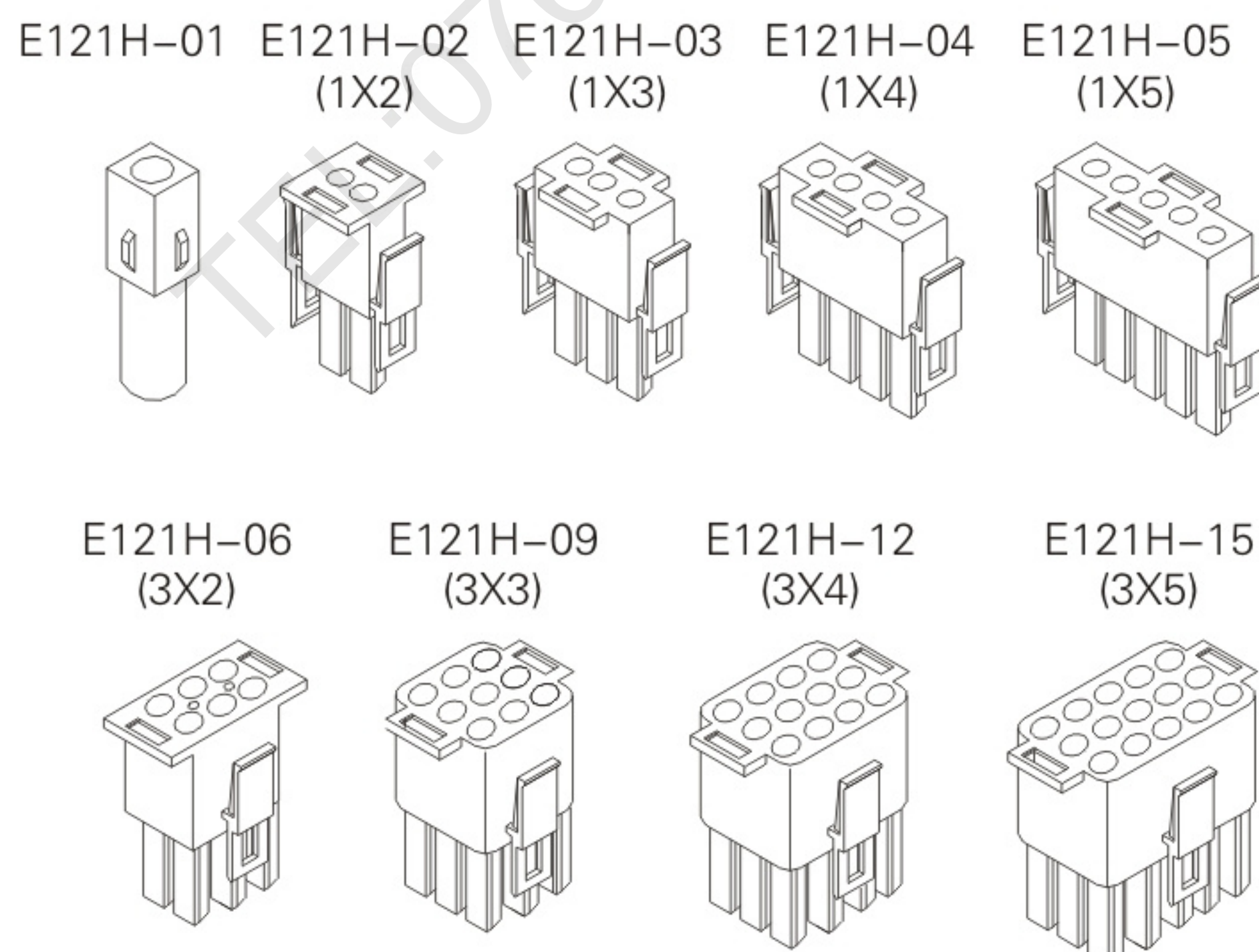

Ordering Information & Dimensions

Circuits	Part No.	DIM.(mm)		
		A	B	C
01	E121H-01	7.4	7.4	28.0
02	E121H-02(1X2)	7.6	14.3	27.9
03	E121H-03(1X3)	7.6	20.7	27.9
04	E121H-04(1X4)	7.6	27.1	27.9
05	E121H-05(1X5)	7.6	33.0	27.9
06	E121H-06(3X2)	20.2	14.2	27.9
09	E121H-09(3X3)	20.2	20.3	27.9
12	E121H-12(3X4)	20.2	26.7	27.9
15	E121H-15(3X5)	20.2	33.0	27.9

E121PS (6.35mm pitch crimp 180° wafer)

Reference Informations:

*Mat'l:body: Nylon 66 UL94V-2

*Pins: Phosphor Bronze Tin Plated

*Mates With : E121H series Housing

*Accepts With : E121 series Terminal

E121PS-06(2x3)

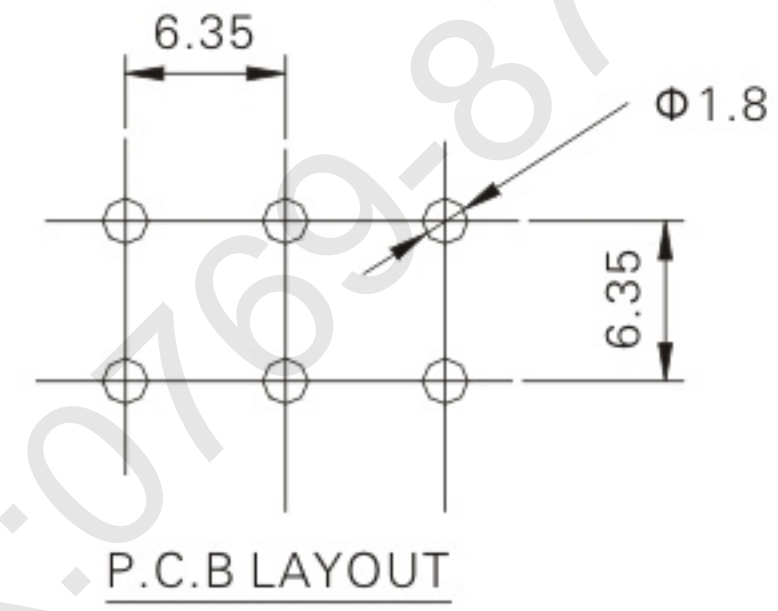
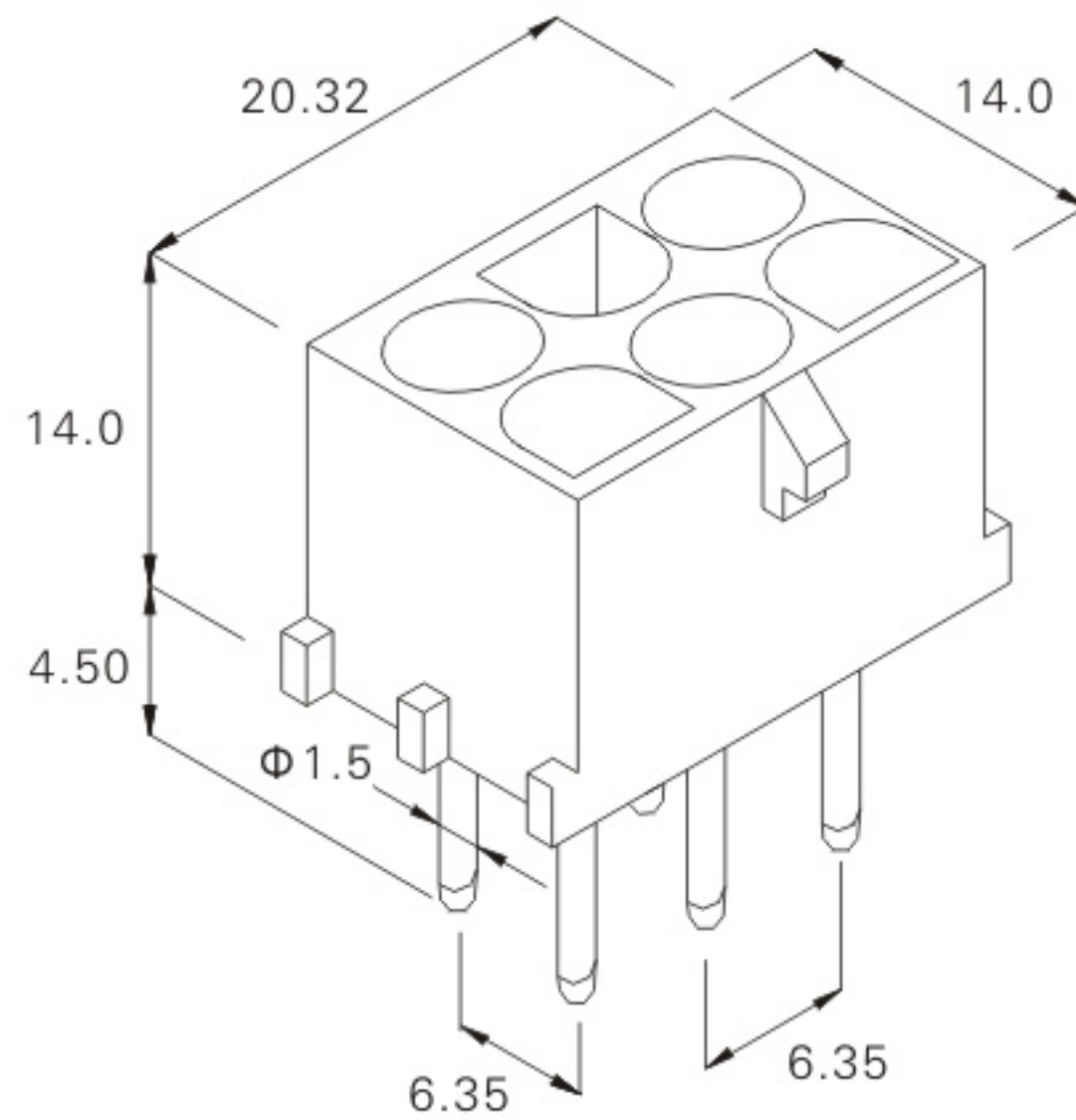

TEL:0769-87937795